

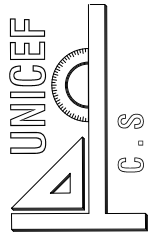



PROJECT NAME : Farich Male Secondary School  
PROJECT EMPLOYER : UNITED NATIONS CHILDREN'S FUND  
PREPARE BY : CONSTRUCTION SECTION

			
TITLE :		PROJECT EMPLOYER	
DRAWING BY		UNITED NATIONS CHILDREN'S FUND	
CHECKED BY		construction section	
APPROVED BY		Farieh Male Secondary School	
SHEET No		All dimension are in cm	
SCALE			
DATE			
C.S			
6			
AS SHOWN			
feb 2024			

S.N	TABLE OF CONTENTS
A-1/8	TABLE OF CONTENT
A-2/8	GOOGLE MAP"ROAD MAP"
A-3/8	GOOGLE MAP"SITE LOCATION"
A-4/8	GENERAL SITE PLAN
A-5/8	EXISTING PLAN
A-6/8	PLANNED BOUNDARY WALL
A-7/8	PROPOSED STONE MASONRY STAIR & RAMP
A-8/8	



	
PROJECT EMPLOYER	
UNITED NATIONS CHILDREN'S FUND	
construction section	
Farich Male Secondary School	
All dimension are in cm	
TITLE :	
DRAWING BY	
SAYED HAFIZ SADAT	
CHECKED BY	
APPROVED BY	
UNICEF	
C.S	
SHEET No	
1	
SCALE	
AS SHOWN	
DATE	
feb 2024	

# Farich Male Secondary School

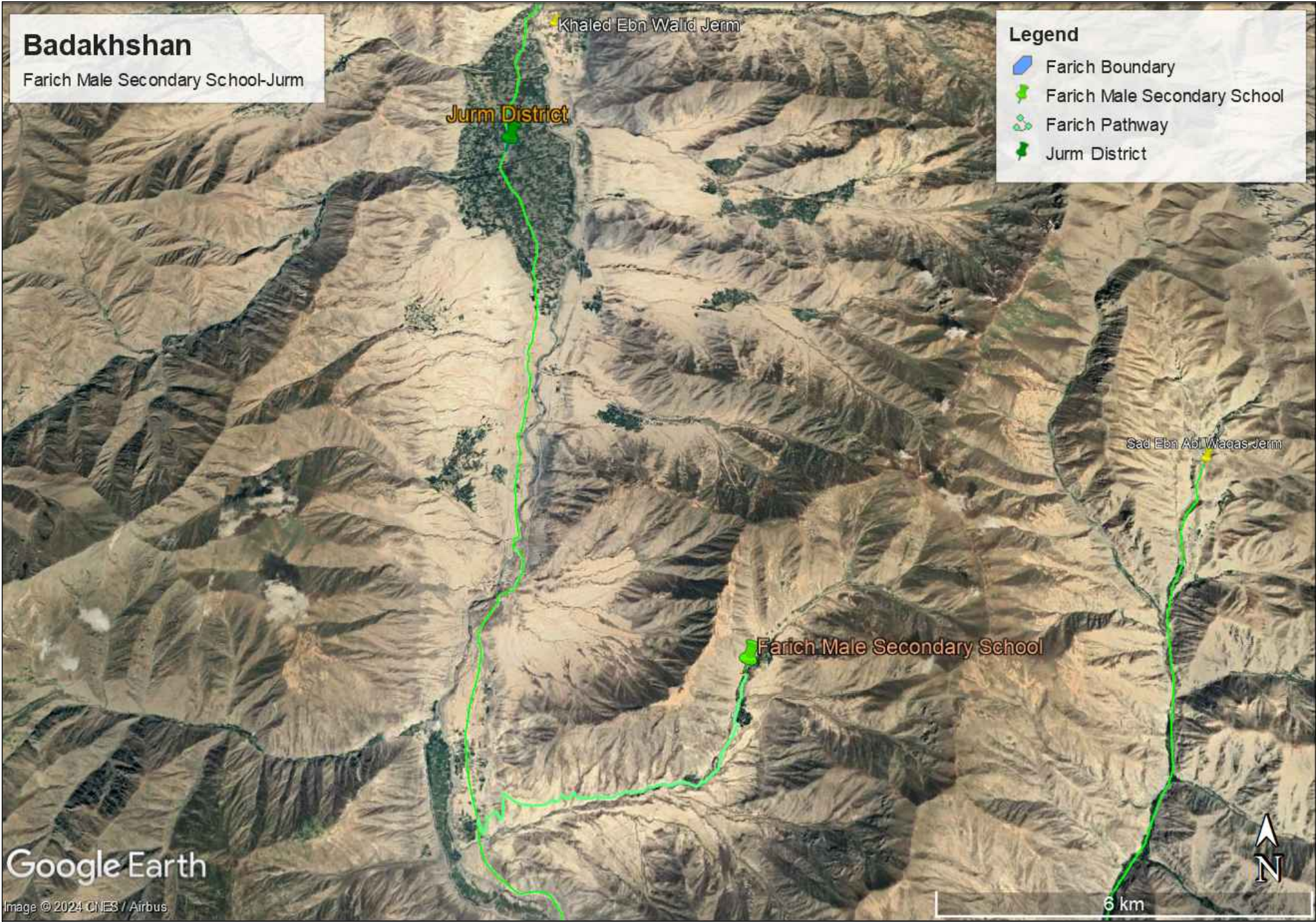

Pathway



	
PROJECT EMPLOYER	
UNITED NATIONS CHILDREN'S FUND	
construction section	
Farich Male Secondary School	
All dimension are in cm	
TITLE :	
DRAWING BY	
SAYED HAFIZ SADAT	
CHECKED BY	
APPROVED BY	
UNICEF	
C.S	
SHEET No	
2	
SCALE	
AS SHOWN	
DATE	
feb 2024	

# Farich Male Secondary School



Site location

UNICEF

C.S

SHEET No3

SCALEAS SHOWN

DATEfeb 2024

TITLE :

DRAWING BY

CHECKED BY

APPROVED BY

PROJECT EMPLOYER

UNITED NATIONS CHILDREN'S FUND

construction section

Farich Male Secondary School

All dimension are in cm

unicef

# Farich Male Secondary School

The site plan illustrates the layout of the Farich Male Secondary School. The central feature is the 'Existing Building', a large rectangle with a width of 32m and a depth of 13m. To its left is a smaller structure labeled 'New Latrine' with a width of 13m and a depth of 20m. The entire school complex is situated within a larger plot that is 33m wide and 5m deep. The surrounding area includes 'Agricultural Land' to the north, south, and west, and a 'Mountain' to the east. Several 'Public House' structures are marked with small squares: three to the north, two to the south, and one to the west. A north arrow is located in the top right corner of the plan.

Site Plan

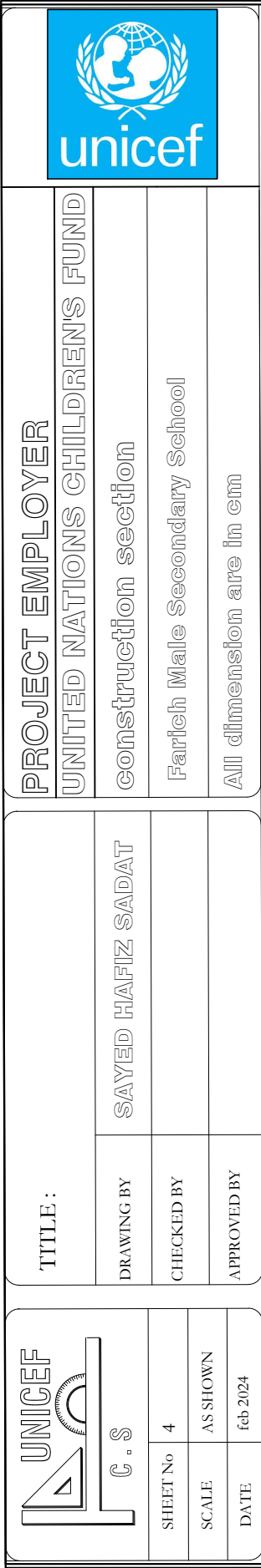

## Existing Plan

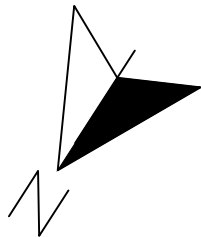

D(1-6)= 100x265 cm  
D(7,8)= 265x290 cm  
D9= 300x265 cm  
W(1-14)=150x180 cm  
Room Height 300cm



UNICEF

C.S

SHEET No5

SCALEAS SHOWN

DATEfeb 2024

TITLE :

DRAWING BY

CHECKED BY

APPROVED BY

SAYED HAFIZ SADAT

PROJECT EMPLOYER

UNITED NATIONS CHILDREN'S FUND

construction section

Farich Male Secondary School Boundary wall

All dimension are in cm



# Farich Male Secondary School Boundary wall

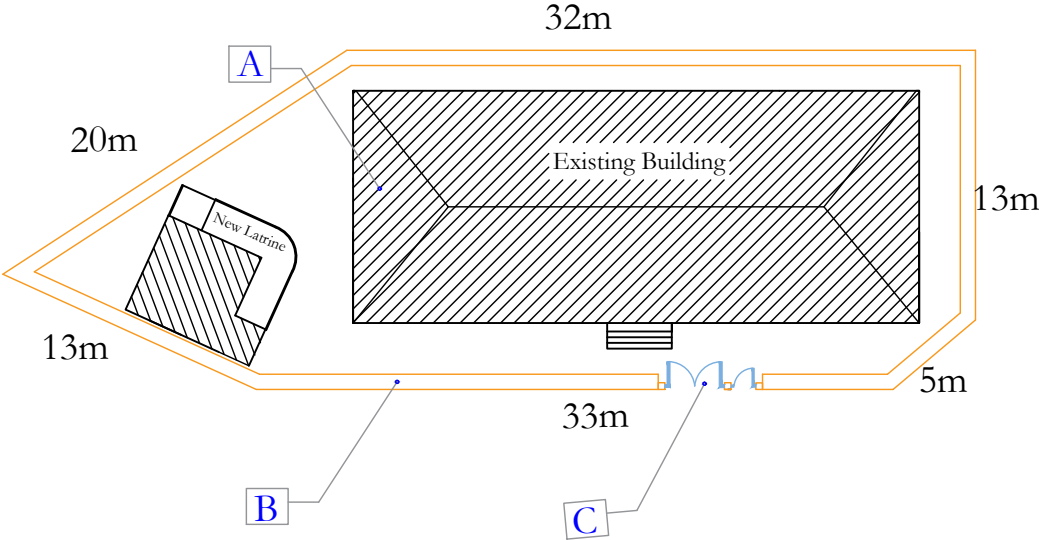

A	Existing Building
B	Planned Boudary wall L=195m
C	Planned Door

Site Plan

UNICEF



SHEET No

6

SCALE

AS SHOWN

DATE

feb 2024

TITLE :

DRAWING BY

SAYED HAFIZ SADAT

CHECKED BY

APPROVED BY

PROJECT EMPLOYER

UNITED NATIONS CHILDREN'S FUND

construction section

Farich Male Secondary School

All dimension are in cm



unicef

Farich Male secondary school

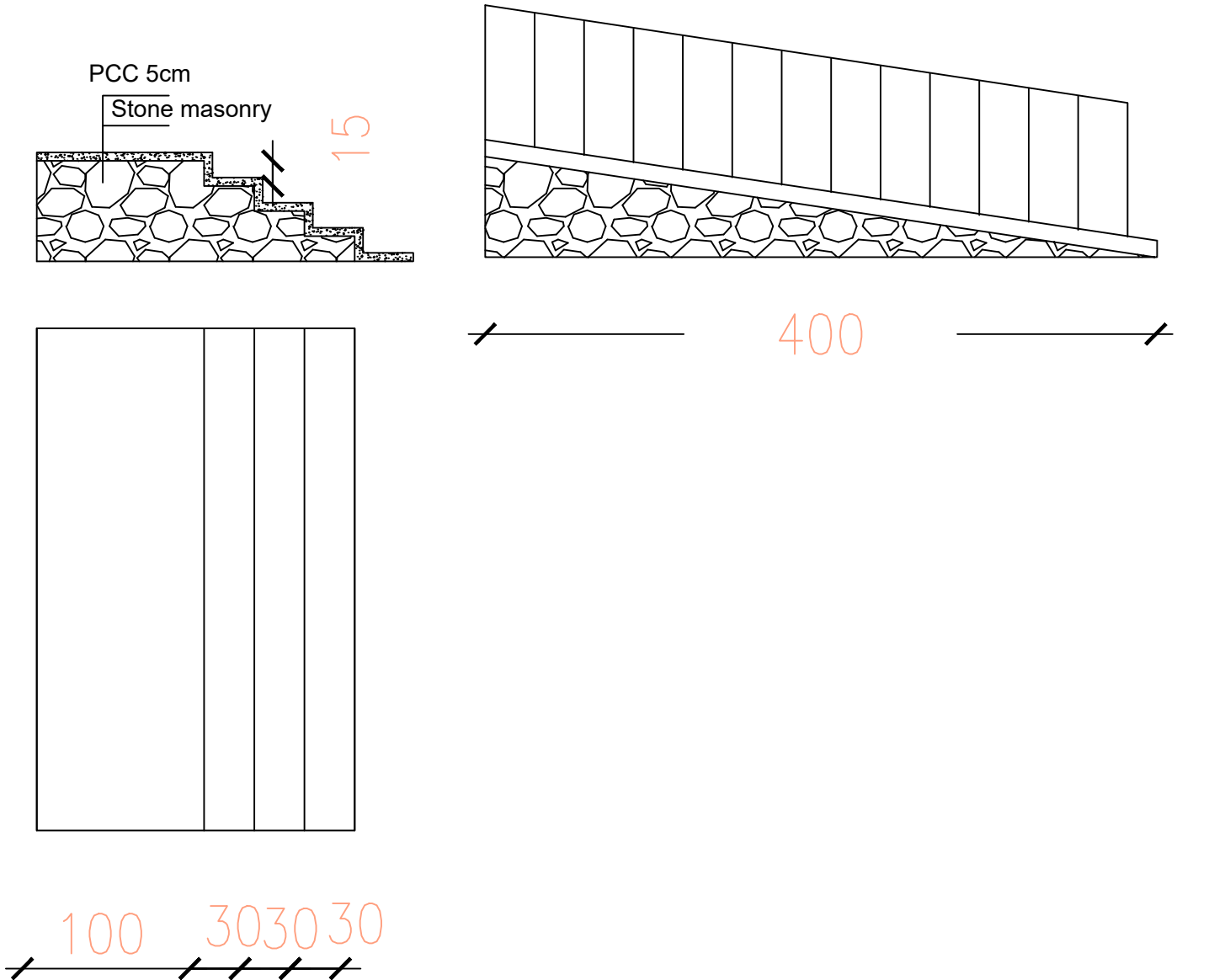

100 30 30 30

60

400

15

PCC 5cm

Stone masonry

Two New Propoed Stone Masonry Stair and Ramp