



PROJECT NAME : Fatemeh Al-Zahra High School

PROJECT EMPLOYER : UNITED NATIONS CHILDREN'S FUND

PREPARE BY : CONSTRUCTION UNIT

<div>UNICEF</div>		TITLE :		PROJECT EMPLOYER			
<div>UNICEF</div>		DRAWING BY		UNITED NATIONS CHILDREN'S FUND		UNITED NATIONS CHILDREN'S FUND	
<div>6.5</div>		CHECKED BY		construction section		construction section	
<div>1</div>		APPROVED BY		Fatemeh Al-Zahra High School		Fatemeh Al-Zahra High School	
<div>AS SHOWN</div>							
<div>DATE</div>						All dimension are in cm	
<div>Jun. 2024</div>							



UNICEF

C.S

SHEET No

2

SCALE

AS SHOWN

DATE

Jun. 2024

TITLE :

DRAWING BY

CHECKED BY

APPROVED BY

PROJECT EMPLOYER

UNITED NATIONS CHILDREN'S FUND

construction section

Fateme Al-Zahra High School

All dimension are in cm



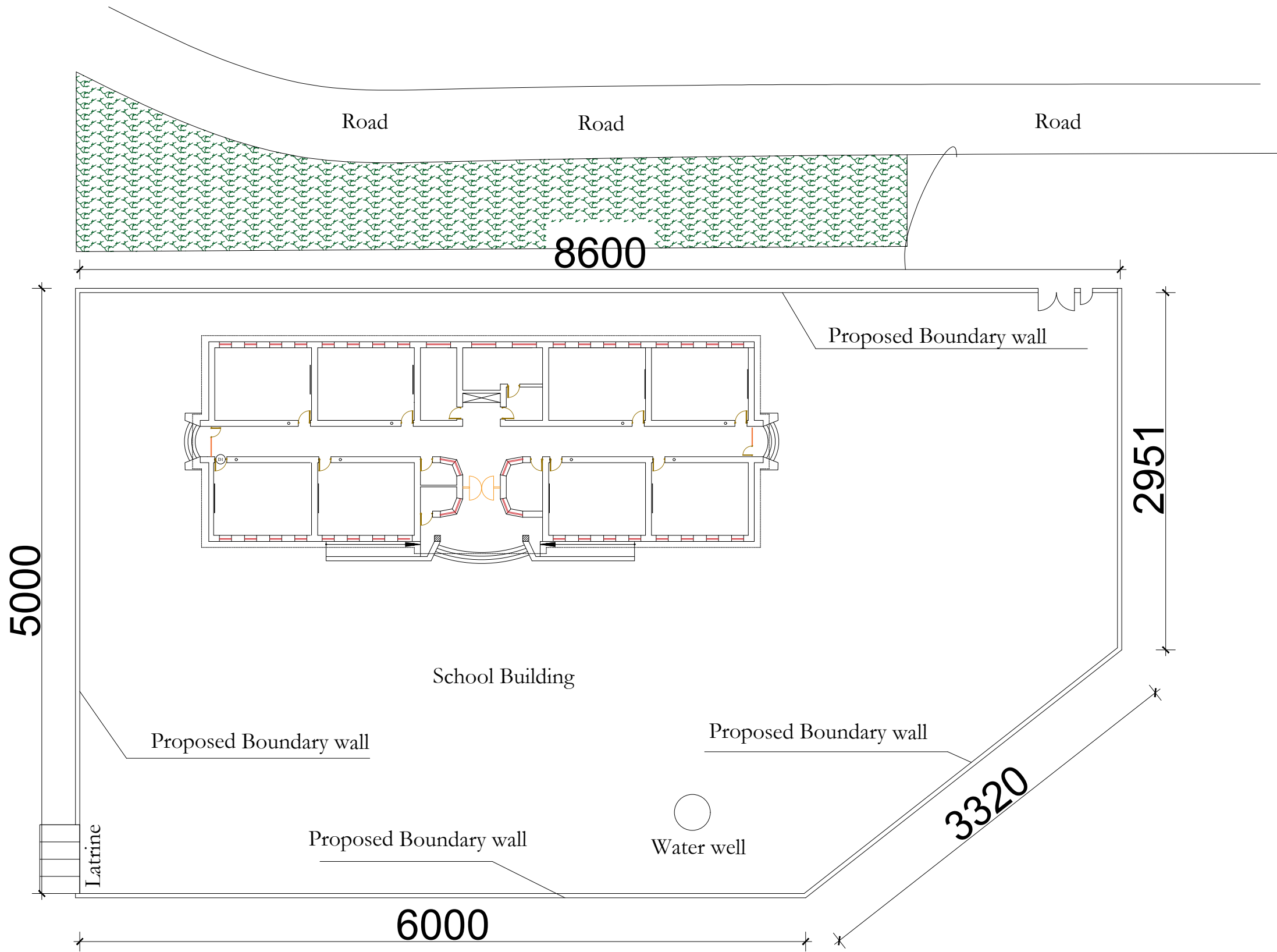



PROJECT EMPLOYER
UNITED NATIONS CHILDREN'S FUND
construction section
Fatemeh Al-Zahra High School
All dimension are in cm

TITLE : SCHOOL PLAN
DRAWING BY
CHECKED BY
APPROVED BY

UNICEF
C.S
SHEET No 3
SCALE AS SHOWN
DATE Jun 2024

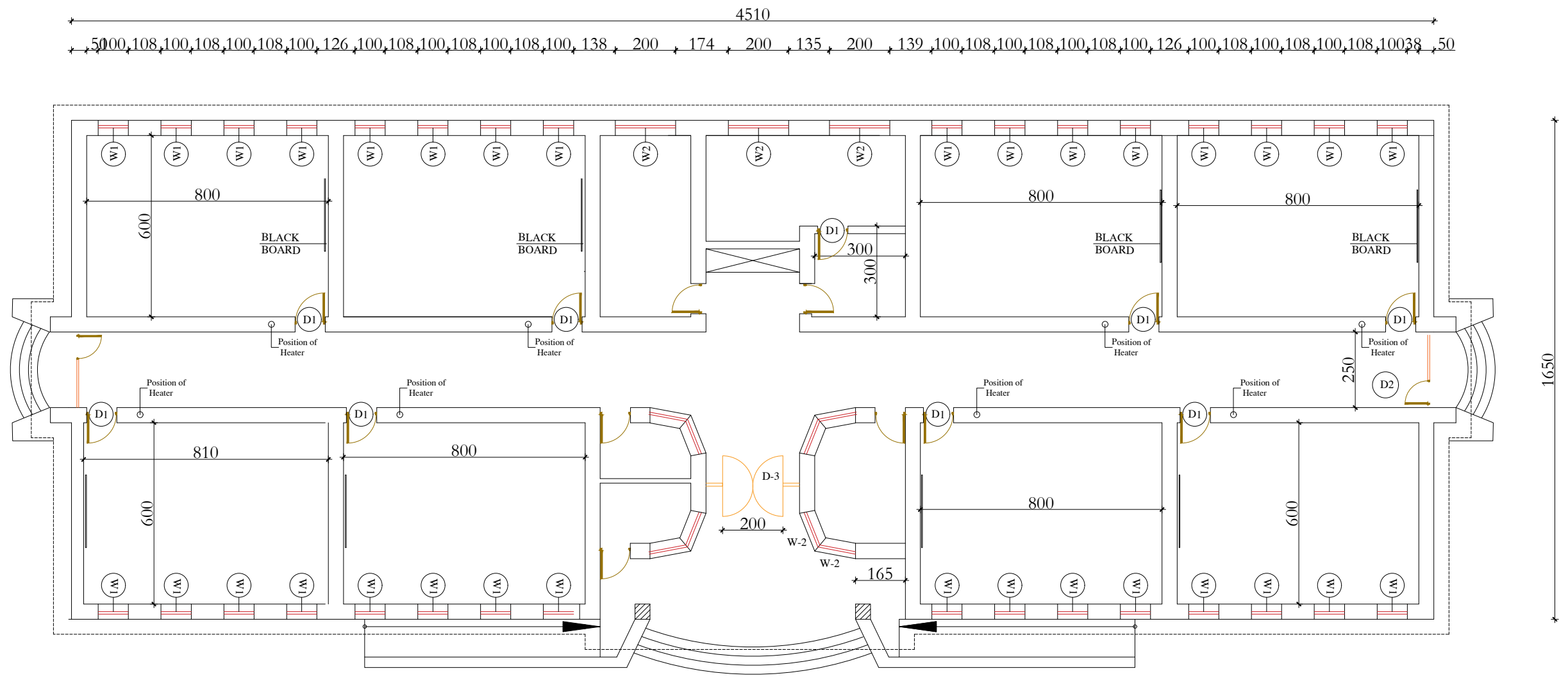

Existence school plan

Door Window	#	Sizes
D1	10	100 x280 cm
DW1	2	180 x280 cm
DW2	2	240 x260 cm
W1	31	120 x170 cm
W2	9	120 x80 cm
H		280 cm
H		350 cm