



Project Name: Dara e Ghar Girls Secondary School

Assessment

Project Employer: UNITED NATIONS CHILDREN'S

FUND

Prepared by: Construction Section

Drawing Sheets

Date 28 February, 2024



Site Plan

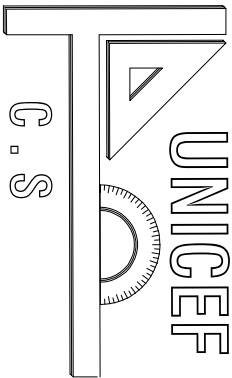

SHEET No

M-1/2

SCALE

AS SHOWN

DATE

Feb . 2024

TITLE : Floor Plan

DRAWING BY

Mohammad Ali Eltaf

CHECKED BY

APPROVED BY

PROJECT EMPLOYER

UNITED NATIONS CHILDREN'S FUND

construction section

Renovation of Dara e Ghar Girls Secondary School

All dimension are in cm

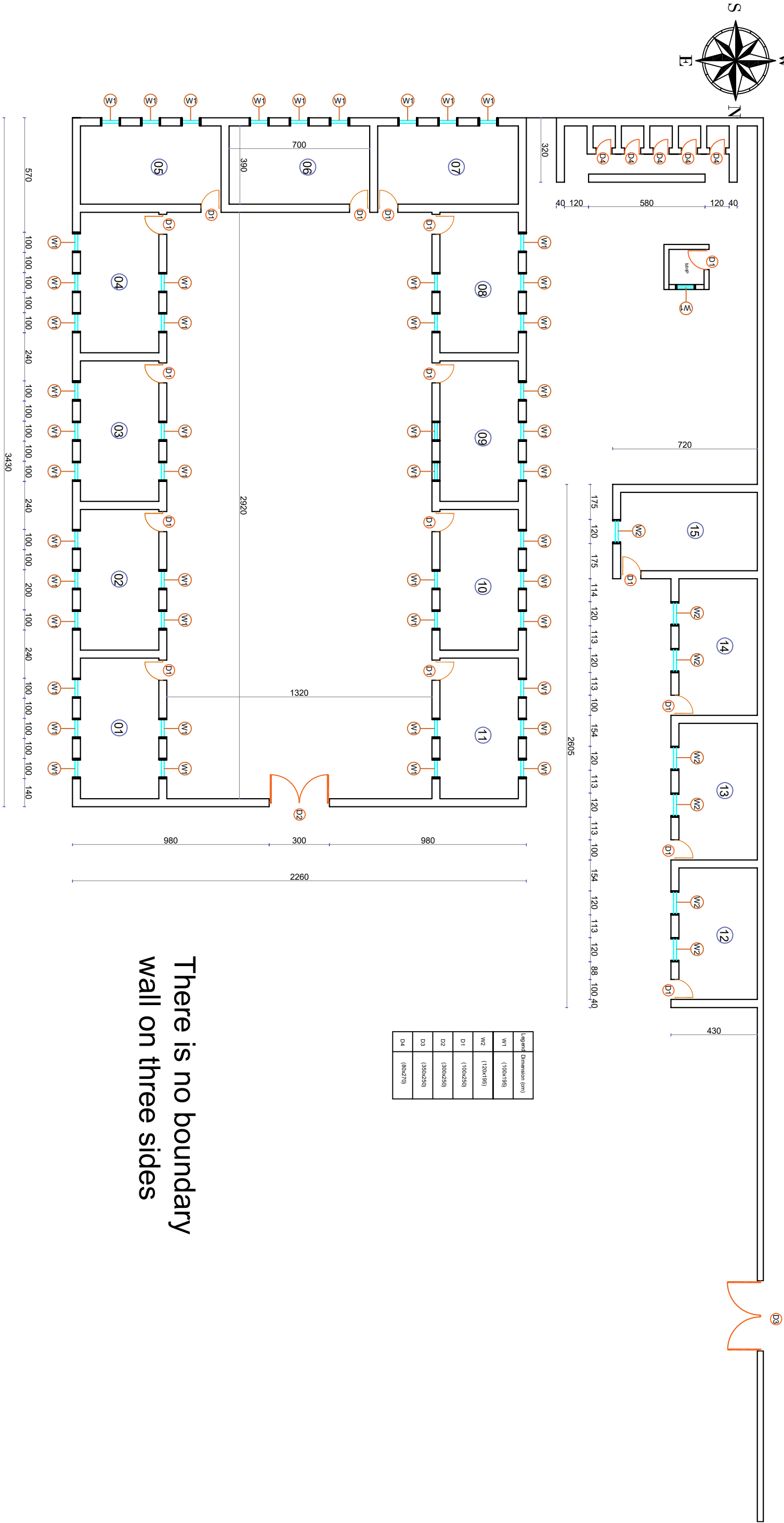
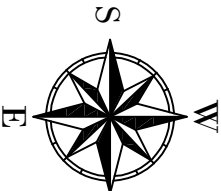

There is no boundary wall on three sides

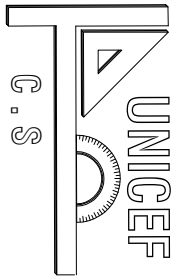

SHEET No	M-1/2
SCALE	AS SHOWN
DATE	Feb . 2024

TITLE : Room Finish Schedule

DRAWING BY	Mohammad Ali Eltaf
CHECKED BY	
APPROVED BY	

PROJECT EMPLOYER  
UNITED NATIONS CHILDRENS FUND

construction section

Renovation of Dara e Ghar Girls Secondary School

All dimension are in cm

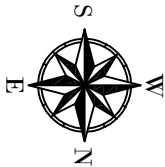

ROOM FINISH SCHEDULE (DARA E GHAR GIRLS SECONDARY SCHOOL)												
Floor#	Room #	Wall		floor		ceiling		Windows and doors			Remark	
		Partial Plaster	Filling	3 coat painting	PCC	Filling	3 coat painting	adjustment	replacement Glazing	Painting		
1 <sup>st</sup> floor	1	1.23 SQM	Full Body (FB)	Full Body (FB)	Partially (2.73 SQM)	FB	FB	5 windows and 1 door	N/A	5 windows	5 windows and 1 door	
	2	1.23 SQM FB		FB	Partially (2.73 SQM)	FB	FB	5 windows and 1 door	N/A	5 windows	5 windows and 1 door	
	3	1.23 SQM FB		FB	Partially (2.73 SQM)	FB	FB	5 windows and 1 door	N/A	5 windows	5 windows and 1 door	
	4	1.23 SQM FB		FB	Partially (2.73 SQM)	FB	FB	5 windows and 1 door	N/A	5 windows	5 windows and 1 door	
	5	1.23 SQM FB		FB	Partially (2.73 SQM)	FB	FB	3 windows and 1 door	N/A	3 windows	3 windows and 1 door	
	6	1.23 SQM FB		FB	Partially (2.73 SQM)	FB	FB	3 windows and 1 door	N/A	3 windows	3 windows and 1 door	
	7	1.23 SQM FB		FB	Partially (2.73 SQM)	FB	FB	3 windows and 1 door	N/A	3 windows	3 windows and 1 door	
	8	1.23 SQM FB		FB	Partially (2.73 SQM)	FB	FB	5 windows and 1 door	N/A	5 windows	5 windows and 1 door	
	9	1.23 SQM FB		FB	Partially (2.73 SQM)	FB	FB	5 windows and 1 door	N/A	5 windows	5 windows and 1 door	
	10	1.23 SQM FB		FB	Partially (2.73 SQM)	FB	FB	5 windows and 1 door	N/A	5 windows	5 windows and 1 door	
	11	1.23 SQM FB		FB	Partially (2.73 SQM)	FB	FB	5 windows and 1 door	N/A	5 windows	5 windows and 1 door	
	12	1.23 SQM FB		FB	Partially (2.73 SQM)	FB	FB	2 windows and 1 door	N/A	2 windows	2 windows and 1 door	
	13	1.23 SQM FB		FB	Partially (2.73 SQM)	FB	FB	2 windows and 1 door	N/A	2 windows	2 windows and 1 door	
	14	1.23 SQM FB		FB	Partially (2.73 SQM)	FB	FB	2 windows and 1 door	N/A	2 windows	2 windows and 1 door	
	15	1.23 SQM FB		FB	Partially (2.73 SQM)	FB	FB	1 windows and 1 door	N/A	1 windows	1 windows and 1 door	

1<sup>st</sup> floor



<div><div>UNICEF</div><div>C . S</div></div>	
SHEET No	M-1/2
SCALE	AS SHOWN
DATE	Feb . 2024

TITLE : Site Plan	
DRAWING BY	Mohammad Ali Eltaf
CHECKED BY	
APPROVED BY	

PROJECT EMPLOYER
UNITED NATIONS CHILDREN'S FUND
construction section
Renovation of Dara e Ghar Girls Secondary School
All dimension are in cm

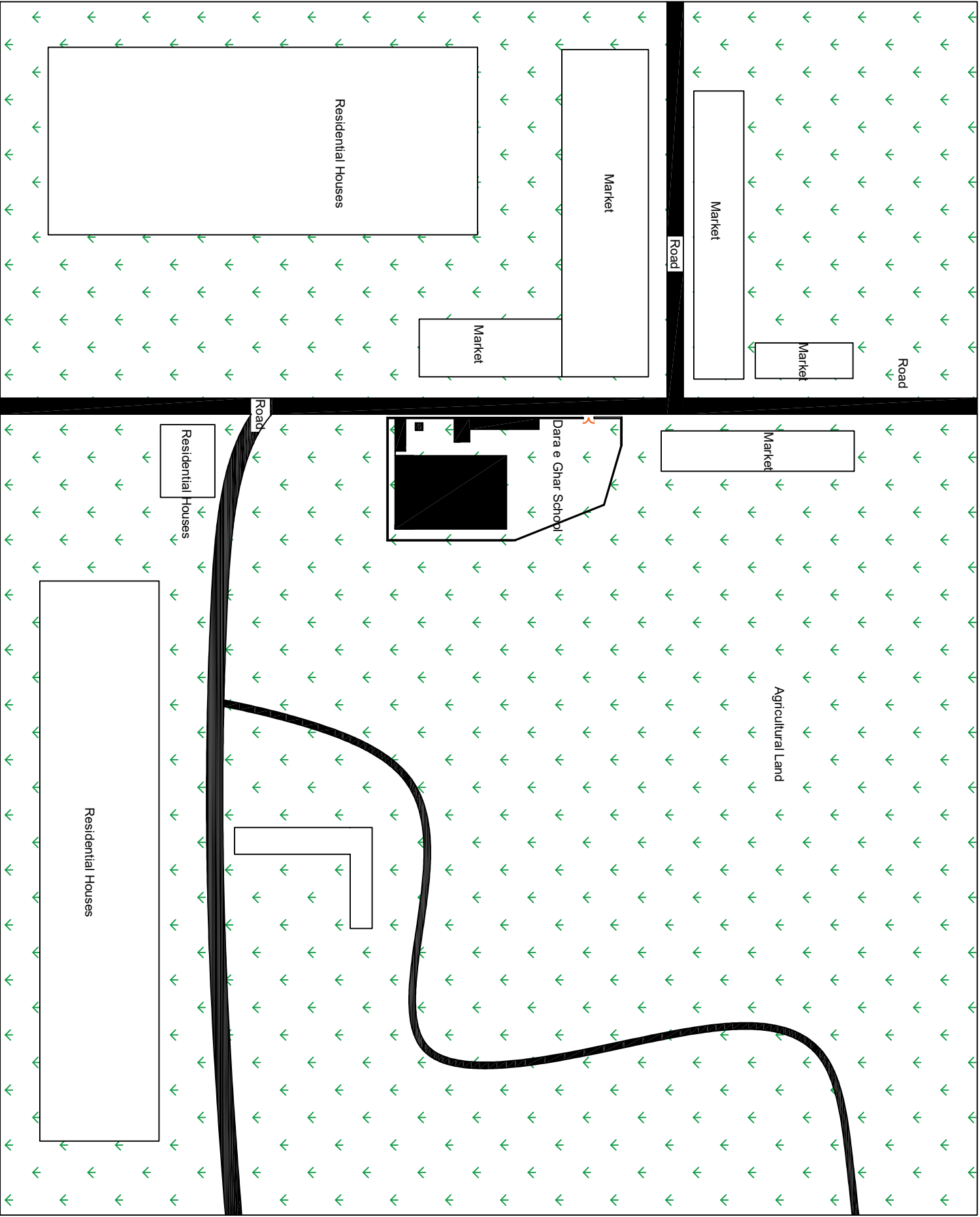
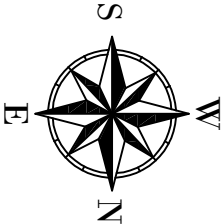

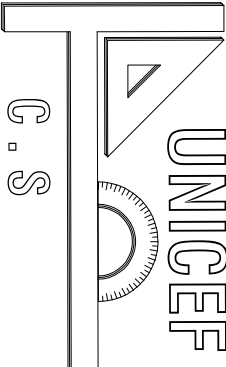

C. S

SHEET No

M-1/2

SCALE

AS SHOWN

DATE

Feb . 2024

TITLE : Boundary Wall Plan

DRAWING BY

Mohammad Ali Eltaf

CHECKED BY

APPROVED BY

PROJECT EMPLOYER

UNITED NATIONS CHILDREN'S FUND

construction section

Renovation of Dara e Ghar Girls Secondary School

All dimension are in cm



7240

3900

Proposed Stone Masonry Wall  
L=208 m

880

1900

3234

3700

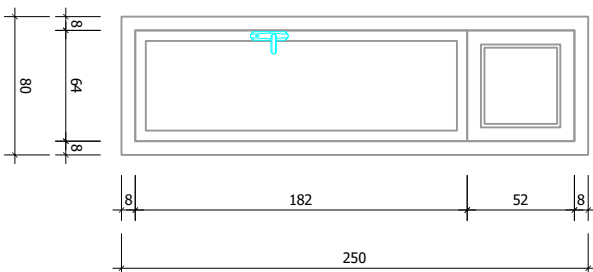
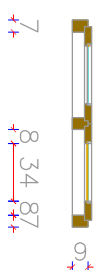
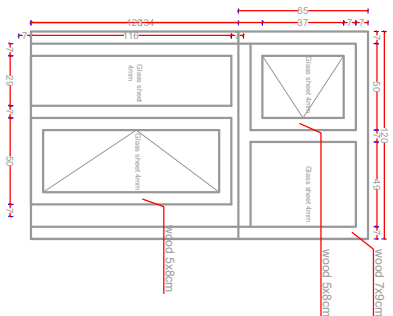
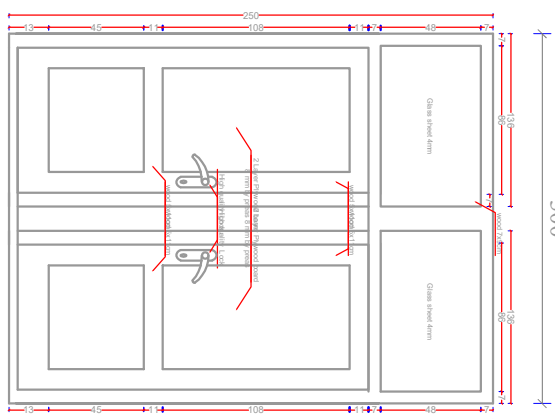
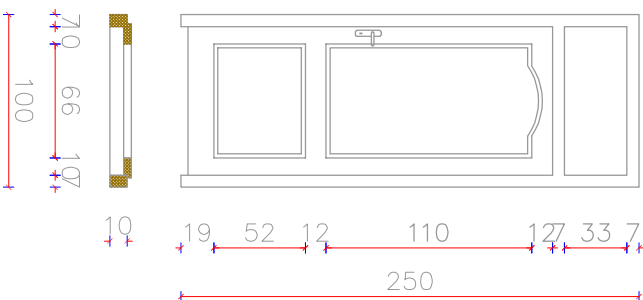
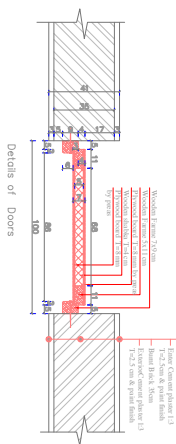
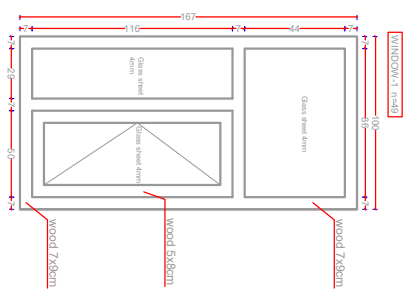

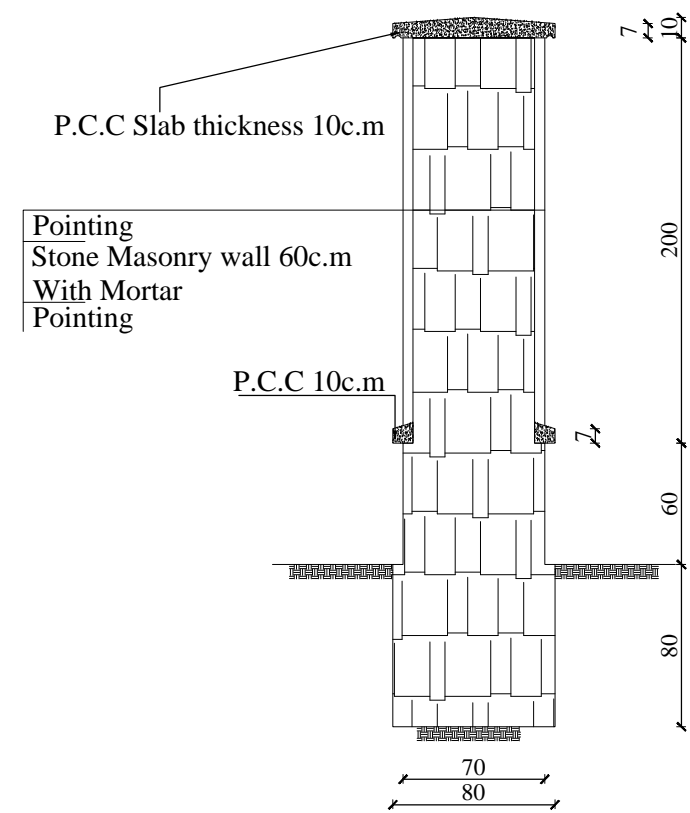

Technical drawing of a wall section. The wall is labeled "Stone Masonry Wall 60 c.m". It shows three square openings. The first opening has a width of 70 and a height of 60. The second opening has a width of 70. The third opening has a width of 70. The distance between the first and second openings is 500. The distance between the second and third openings is 500. The distance between the third opening and the right end is 70. A section line "A-A" is shown at the left end. A note "4c.m Construction joint After 15m-20m" points to a vertical line between the third and fourth openings. The drawing is labeled "4" at the bottom right.

$$\mathbf{L} = \dots\dots\dots$$

